



Alex & Matteo
ESTATE AGENTS



Tower Bridge Buildings, SE1 2AZ

A beautifully presented two-bedroom apartment ideally positioned moments from the iconic Tower Bridge, a short stroll from Bermondsey Underground Station, and perfectly situated beside the vibrant Shad Thames district. This stylish home features a contemporary fully fitted kitchen, a bright and spacious reception room with ample space for dining and entertaining, a generous principal double bedroom, and a versatile second room ideal as a guest bedroom, home office, or creative workspace.

A modern, well-maintained bathroom and additional hallway storage further enhance the practicality of the apartment. Residents benefit from an exceptional range of nearby amenities, including independent cafés, popular bars and restaurants, boutique shops, local markets, and fitness facilities, all contributing to the lively atmosphere of this sought-after riverside neighbourhood.

- Stylish One Bedroom Apartment
- Excellent Location
- Good Transport Links
- Plenty of Storage
- Surrounded by Local Amenities
- Furnished

£2,300 Per month

Alex & Matteo
ESTATE AGENTS

Tower Bridge Buildings, SE1

Approximate Area = 675 sq ft / 62.7 sq m

For identification only - Not To Scale

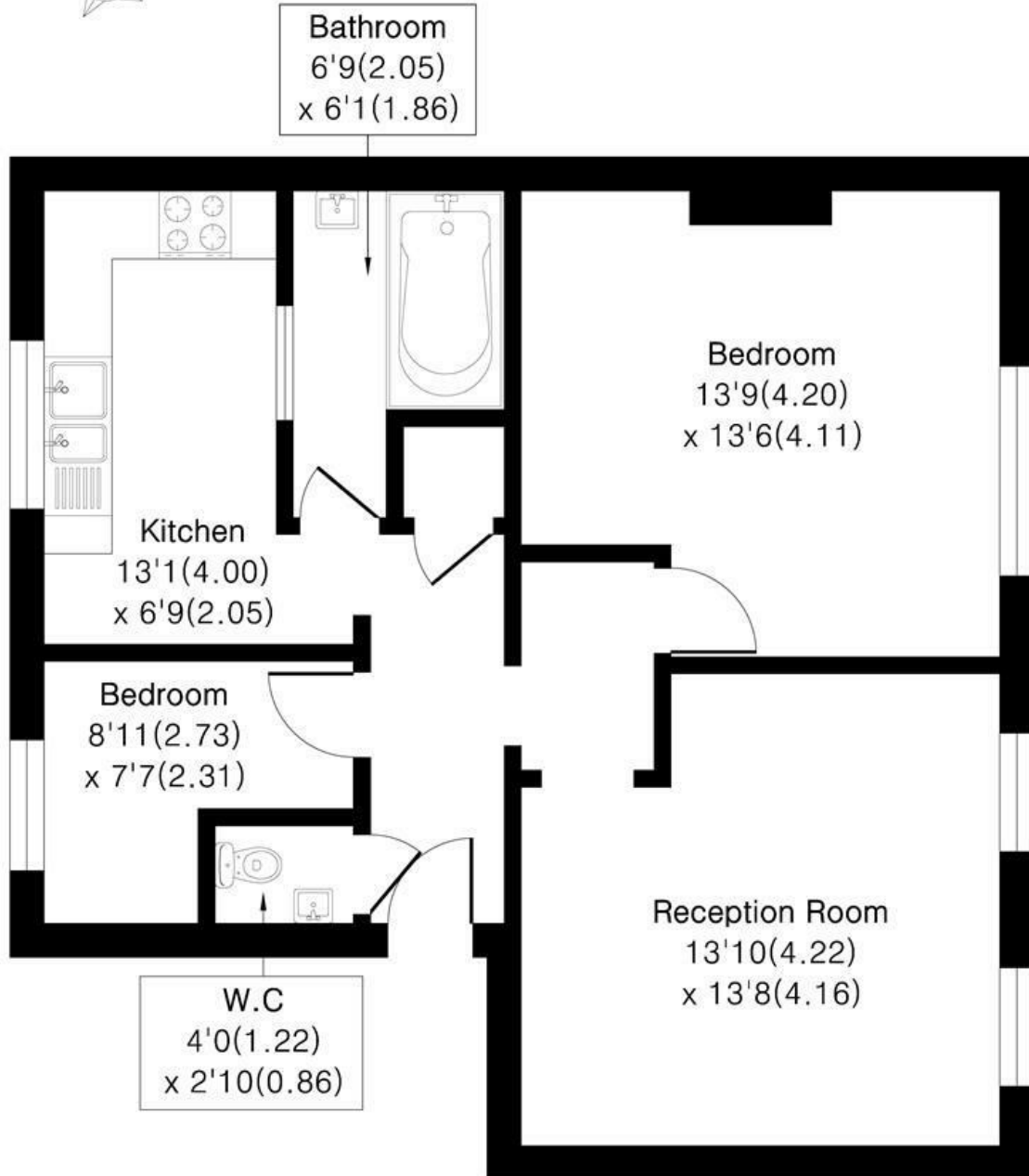

Floor plan Produced in accordance with RICS Property Measurement 2nd Edition.
Incorporating International Property Measurement Standards (IPMS2 Residential).
Produced for Alex & Matteo Estate Agents.



Energy Efficiency Rating		Current	Potential
Very energy efficient - lower running costs			
(92 plus) A			
(81-91) B			
(69-80) C		74	81
(55-68) D			
(39-54) E			
(21-38) F			
(1-20) G			
Not energy efficient - higher running costs			
England & Wales		EU Directive 2002/91/EC	